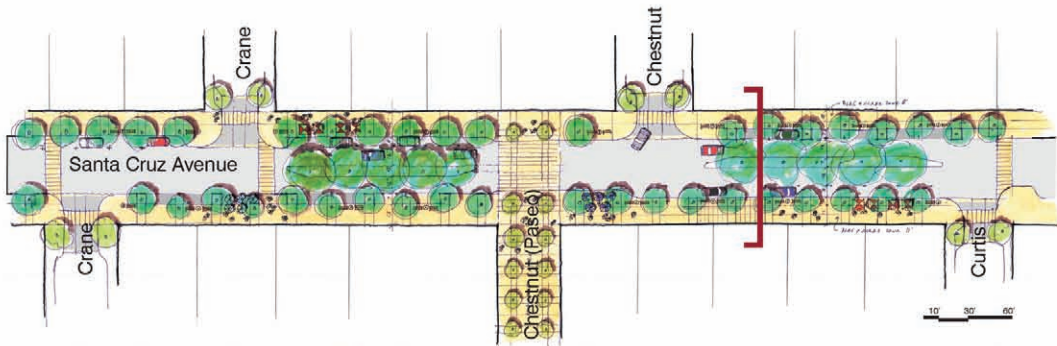
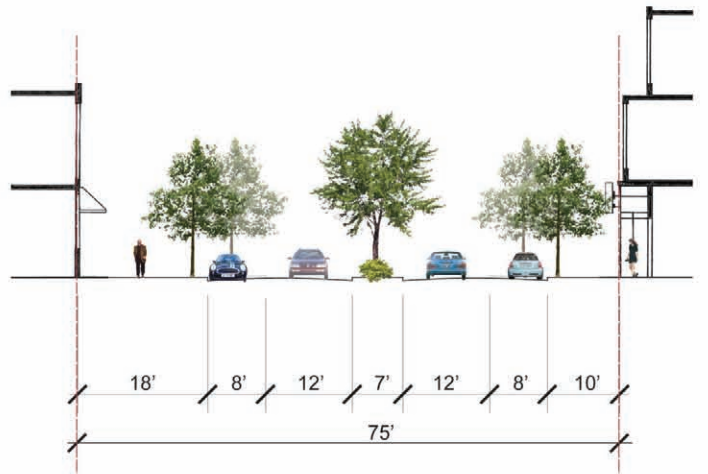


Santa Cruz Avenue Streetscape Concepts

Option 1: Moderate Streetscape Improvements (Median Trees Retained)



Plan of Santa Cruz Avenue with major Streetscape Improvements



Section through Santa Cruz Avenue

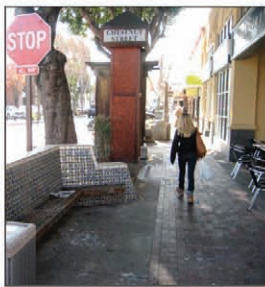
- New Street Design with Diagonal Parking Removed and Median Trees Retained
- Two Traffic Lanes with Parallel Parking
- One Narrow Sidewalk and One Wide Sidewalk



12' wide sidewalk, Palo Alto, CA

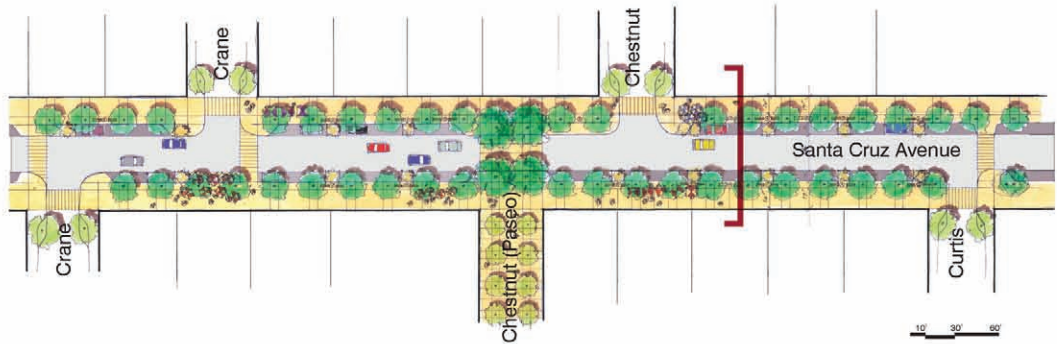


Illustration of 18' wide sidewalk

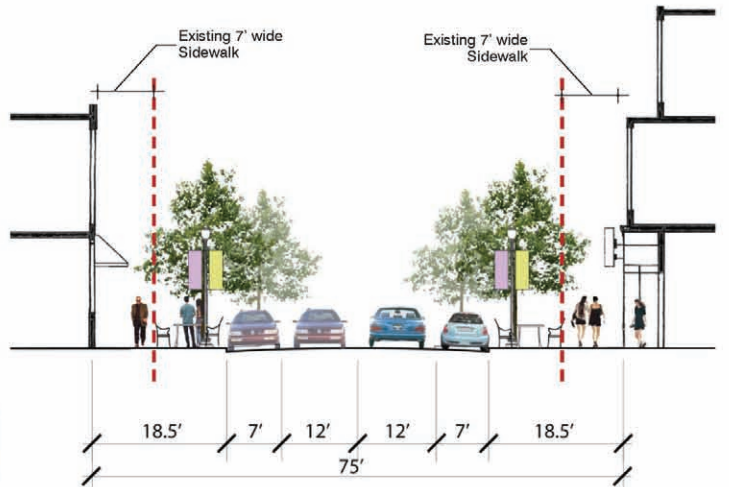


Existing Santa Cruz Ave.

Option 2: Major Streetscape Improvements (Median Trees Removed)



Plan of Santa Cruz Avenue with major Streetscape Improvements



Section through Santa Cruz Avenue

- New Street Design with Diagonal Parking and Median Trees Removed
- Two Traffic Lanes with Parallel Parking
- Two Extra-Wide Sidewalks



18'-20' Pacific Avenue, Santa Cruz, CA



Illustration of 18.5' wide sidewalk



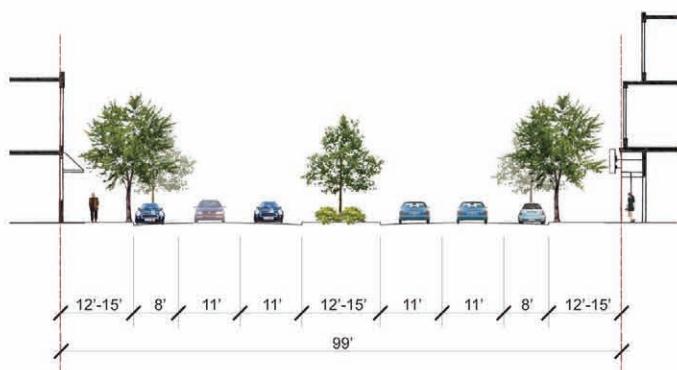
Existing Santa Cruz Ave.

Santa Cruz Sidewalk Options Comparison

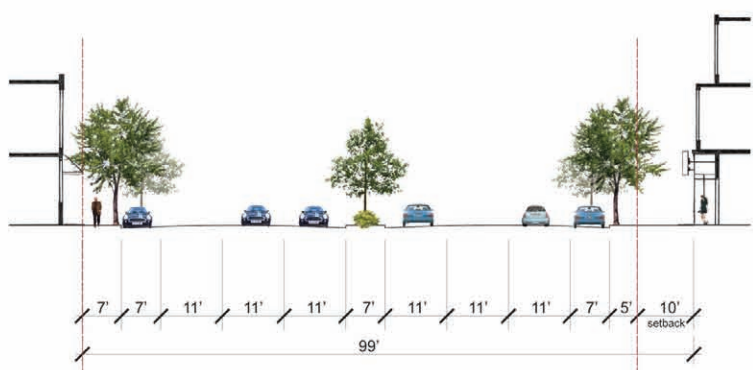
Santa Cruz Sidewalk Options		Sidewalk Character	Sidewalk Width	Space for Pedestrian Circulation	Space for street furnishing/Benches	Space for retail Outdoor seating and Dining	Space for Outdoor Vendors
Existing Sidewalks	2 very narrow sidewalks	Sub-Standard	7-7.5 ft	•			
Option 1	1 narrow sidewalk and 1 wide sidewalk*	Minimum	10-12 ft	•	•		
		Ample	18 - 20 ft	•	•	•	•
Option 2	2 equal wide sidewalks	Ample	18 - 20 ft	•	•	•	•

*alternating from one side to the other of the street

El Camino Real Streetscape Concept



El Camino Real Downtown - Proposed Cross-Section



El Camino Real South - Proposed Cross-Section